

# BEAL CITY SCHOOLS

## CAFETERIA ADDITION

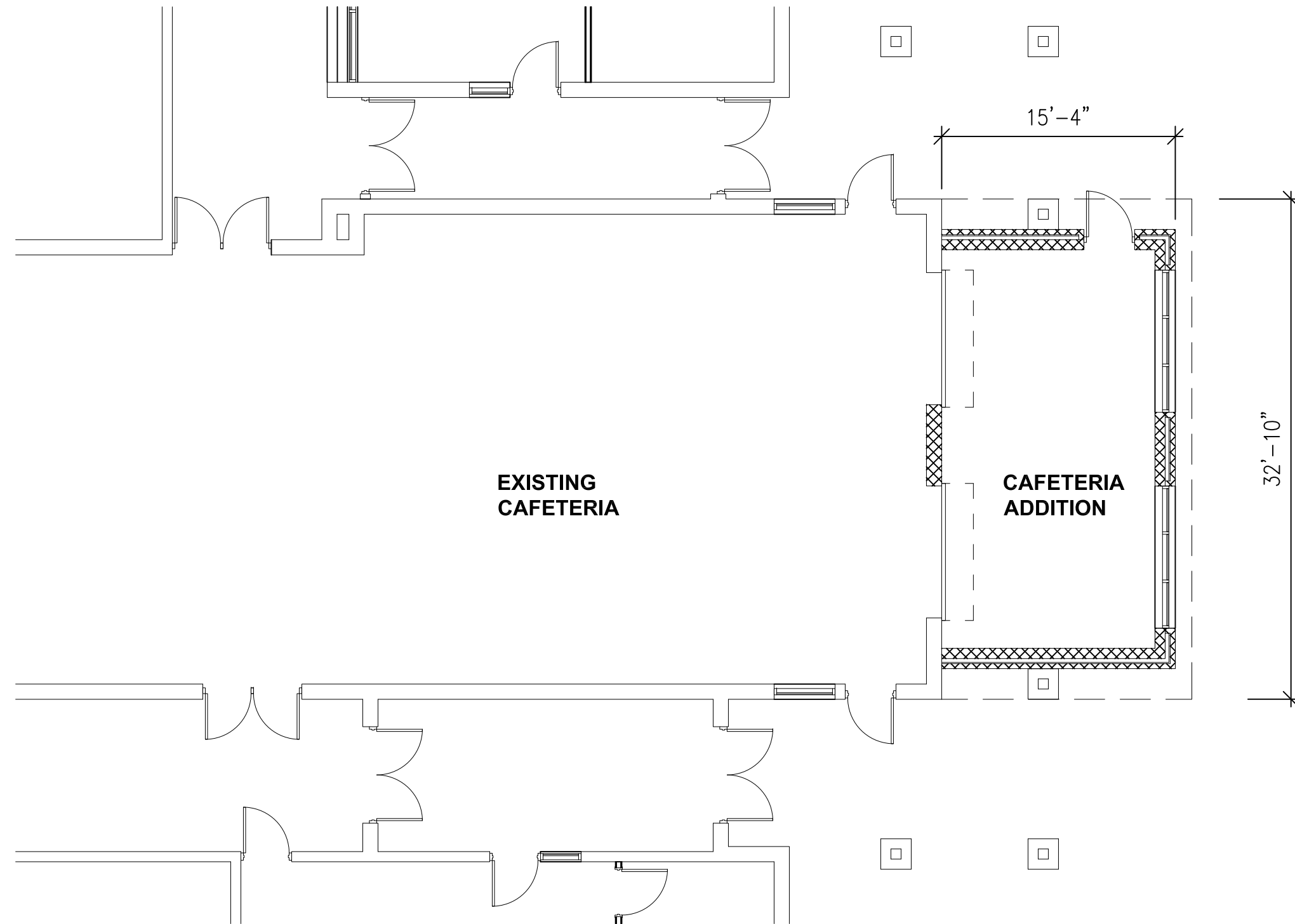

**CONCEPT PLAN**

SCALE: 1/8" = 1'-0"

500 SF NEW CONSTRUCTION

2/8/23

INTEGRATED  
DESIGNS  
INC.

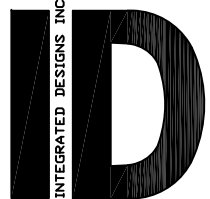

**ARCHITECTURE  
ENGINEERING  
CONSULTING**

MARQUETTE OFFICE:  
1021 W. BARAGA AVENUE  
MARQUETTE, MI 49855  
PHONE: (906)228-4480  
FAX: (906)228-7524

BRIGHTON OFFICE:  
8571 W. GRAND RIVER AVE., SUITE 600  
BRIGHTON, MI 48816  
PHONE: (810)229-2701  
FAX: (810)229-6767